

# Y- INSCHROEF PIF Ø10-G3/8 PPSU

## Product Images

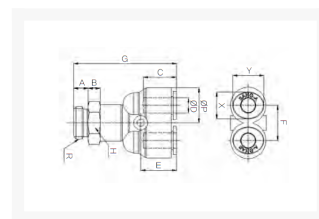

## Omschrijving

De push-in fitting heeft een PPSU body, de draad is uitgevoerd in RVS316.

## Afmetingen

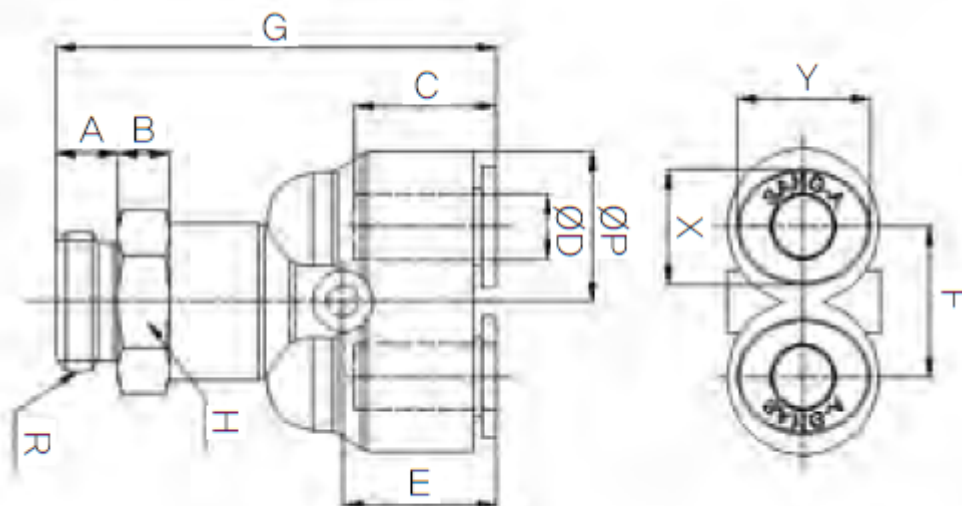

| MODEL        | ØD | ØP   | A   | B | C    | E    | F    | G    | R      | H  | X    | Y    |
|--------------|----|------|-----|---|------|------|------|------|--------|----|------|------|
| HR-PWT 04G01 | 4  | 11.9 | 5.3 | 8 | 14.9 | 13.6 | 11   | 41.3 | PF 1/8 | 13 | 8.6  | 10.8 |
| HR-PWT 04G02 | 4  | 11.9 | 6   | 8 | 14.9 | 13.6 | 11   | 42   | PF 1/4 | 17 | 8.6  | 10.8 |
| HR-PWT 06G01 | 6  | 14.9 | 5.3 | 8 | 15.7 | 15   | 13.6 | 45.3 | PF 1/8 | 15 | 11   | 13   |
| HR-PWT 06G02 | 6  | 14.9 | 6   | 8 | 15.7 | 15   | 13.6 | 46   | PF 1/4 | 17 | 11   | 13   |
| HR-PWT 08G01 | 8  | 16.9 | 5.3 | 8 | 17.8 | 18.6 | 15.4 | 52.9 | PF 1/8 | 17 | 13   | 15   |
| HR-PWT 08G02 | 8  | 16.9 | 6   | 8 | 17.8 | 18.6 | 15.4 | 53.6 | PF 1/4 | 17 | 13   | 15   |
| HR-PWT 08G03 | 8  | 16.9 | 7   | 8 | 17.8 | 18.6 | 15.4 | 54.6 | PF 3/8 | 20 | 13   | 15   |
| HR-PWT 10G02 | 10 | 19.5 | 6   | 8 | 19.8 | 18.4 | 18   | 55.4 | PF 1/4 | 20 | 16   | 18.5 |
| HR-PWT 10G03 | 10 | 19.5 | 7   | 8 | 19.8 | 18.4 | 18   | 56.4 | PF 3/8 | 20 | 16   | 18.5 |
| HR-PWT 10G04 | 10 | 19.5 | 8.5 | 8 | 19.8 | 18.4 | 18   | 57.9 | PF 1/2 | 24 | 16   | 18.5 |
| HR-PWT 12G02 | 12 | 23.5 | 6   | 8 | 22.4 | 20.9 | 21.5 | 61.9 | PF 1/4 | 24 | 19.5 | 22.5 |
| HR-PWT 12G03 | 12 | 23.5 | 7   | 8 | 22.4 | 20.9 | 21.5 | 62.9 | PF 3/8 | 24 | 19.5 | 22.5 |
| HR-PWT 12G04 | 12 | 23.5 | 8.5 | 8 | 22.4 | 20.9 | 21.5 | 64.4 | PF 1/2 | 24 | 19.5 | 22.5 |

## Additional Information

---

|               |               |
|---------------|---------------|
| EAN Code      | 8719426564134 |
| Artikelnummer | HRPWT10-G03   |
| Aansluiting 1 | Buitendraad   |
| Merk          | Sang-A        |
| Fabrikant     | Sang-A        |
| Materiaal     | PPSU          |
| Diameter      | 10mm          |
| Draadmaat 1   | 3/8"          |
| Draadsoort 1  | BSPP          |
| Vorm          | Y             |