

Y- INSCHROEF PIF Ø04-G1/8 PPSU

Product Images

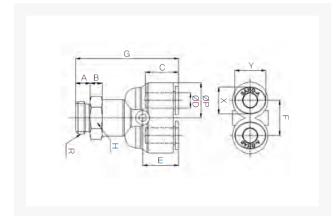

Omschrijving

De push-in fitting heeft een PPSU body, de draad is uitgevoerd in RVS316.

Afmetingen

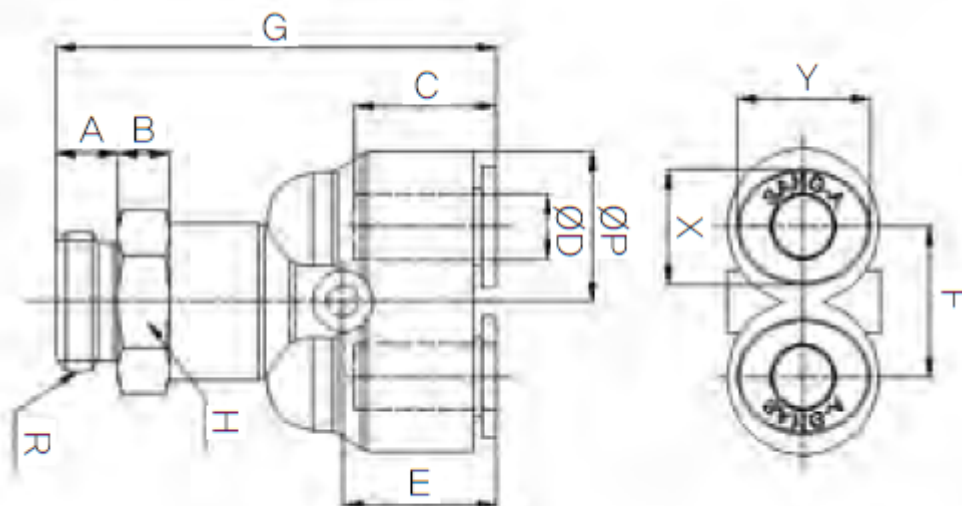

MODEL	ØD	ØP	A	B	C	E	F	G	R	H	X	Y
HR-PWT 04G01	4	11.9	5.3	8	14.9	13.6	11	41.3	PF 1/8	13	8.6	10.8
HR-PWT 04G02	4	11.9	6	8	14.9	13.6	11	42	PF 1/4	17	8.6	10.8
HR-PWT 06G01	6	14.9	5.3	8	15.7	15	13.6	45.3	PF 1/8	15	11	13
HR-PWT 06G02	6	14.9	6	8	15.7	15	13.6	46	PF 1/4	17	11	13
HR-PWT 08G01	8	16.9	5.3	8	17.8	18.6	15.4	52.9	PF 1/8	17	13	15
HR-PWT 08G02	8	16.9	6	8	17.8	18.6	15.4	53.6	PF 1/4	17	13	15
HR-PWT 08G03	8	16.9	7	8	17.8	18.6	15.4	54.6	PF 3/8	20	13	15
HR-PWT 10G02	10	19.5	6	8	19.8	18.4	18	55.4	PF 1/4	20	16	18.5
HR-PWT 10G03	10	19.5	7	8	19.8	18.4	18	56.4	PF 3/8	20	16	18.5
HR-PWT 10G04	10	19.5	8.5	8	19.8	18.4	18	57.9	PF 1/2	24	16	18.5
HR-PWT 12G02	12	23.5	6	8	22.4	20.9	21.5	61.9	PF 1/4	24	19.5	22.5
HR-PWT 12G03	12	23.5	7	8	22.4	20.9	21.5	62.9	PF 3/8	24	19.5	22.5
HR-PWT 12G04	12	23.5	8.5	8	22.4	20.9	21.5	64.4	PF 1/2	24	19.5	22.5

Additional Information

EAN Code	8719426563960
Artikelnummer	HRPWT04-G01
Aansluiting 1	Buitendraad
Merk	Sang-A
Fabrikant	Sang-A
Materiaal	PPSU
Diameter	4mm
Draadmaat 1	1/8"
Draadsoort 1	BSPP
Vorm	Y