

L- INSCHROEF PIF Ø10-G1/2 PPSU

Product Images

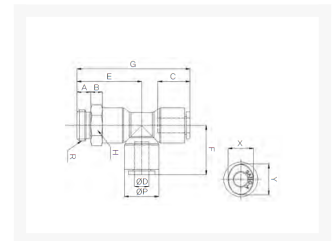

Omschrijving

De push-in fitting heeft een PPSU body, de draad is uitgevoerd in RVS316.

Afmetingen

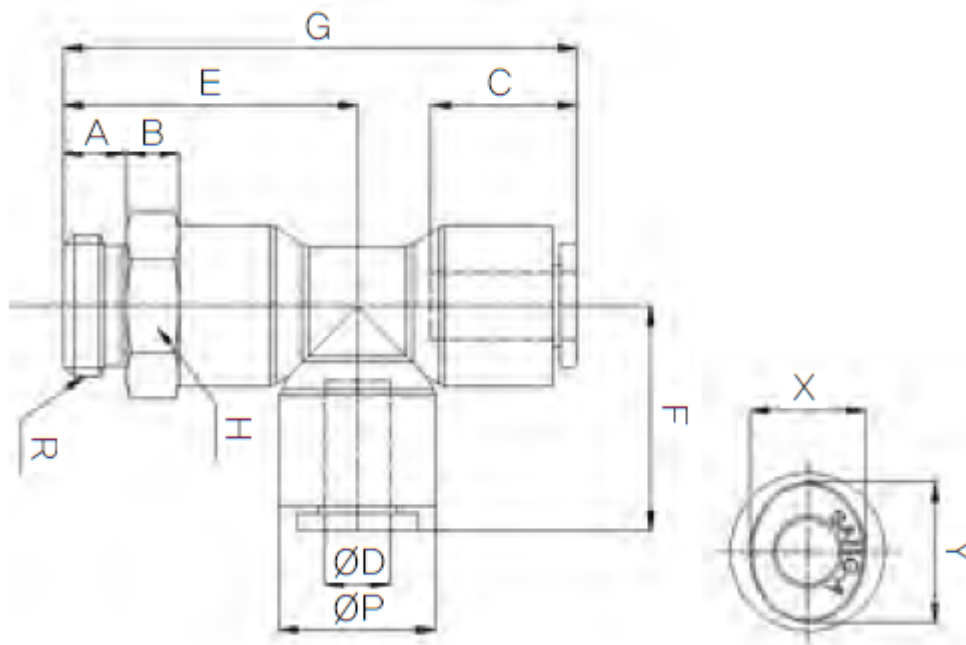

MODEL	ØD	ØP	A	B	C	E	F	G	R	H	X	Y
HR-PST 04G01	4	11.9	5.3	8	14.9	27.8	18.5	46.3	PF 1/8	13	8.6	10.8
HR-PST 04G02	4	11.9	6	8	14.9	28.5	18.5	47	PF 1/4	17	8.6	10.8
HR-PST 06G01	6	14.9	5.3	8	15.7	30.3	21	51.3	PF 1/8	15	11	13
HR-PST 06G02	6	14.9	6	8	15.7	31	21	52	PF 1/4	17	11	13
HR-PST 08G01	8	16.9	5.3	8	17.8	32.3	23.6	55.9	PF 1/8	17	13	15
HR-PST 08G02	8	16.9	6	8	17.8	33	23.6	56.6	PF 1/4	17	13	15
HR-PST 08G03	8	16.9	7	8	17.8	34	23.6	57.6	PF 3/8	20	13	15
HR-PST 10G02	10	19.5	6	8	19.8	35	26.4	61.4	PF 1/4	20	16	18.5
HR-PST 10G03	10	19.5	7	8	19.8	36	26.4	62.4	PF 3/8	20	16	18.5
HR-PST 10G04	10	19.5	8.5	8	19.8	37.5	26.4	63.9	PF 1/2	24	16	18.5
HR-PST 12G02	12	23.5	6	8	22.4	39	30.9	69.9	PF 1/4	24	19.5	22.5
HR-PST 12G03	12	23.5	7	8	22.4	40	30.9	70.9	PF 3/8	24	19.5	22.5
HR-PST 12G04	12	23.5	8.5	8	22.4	41.5	30.9	72.4	PF 1/2	24	19.5	22.5

Additional Information

EAN Code	8719426563816
Artikelnummer	HRPST10-G04
Aansluiting 1	Buitendraad
Merk	Sang-A
Fabrikant	Sang-A
Materiaal	PPSU
Diameter	10mm
Draadmaat 1	1/2"
Draadsoort 1	BSPP
Vorm	L