

# Y- INSCHROEF PIF Ø12-G1/2 PVDF

## Product Images

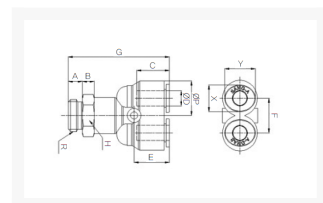

## Omschrijving

De push-in fitting heeft een PVDF body, de draad is uitgevoerd in RVS316.

## Afmetingen

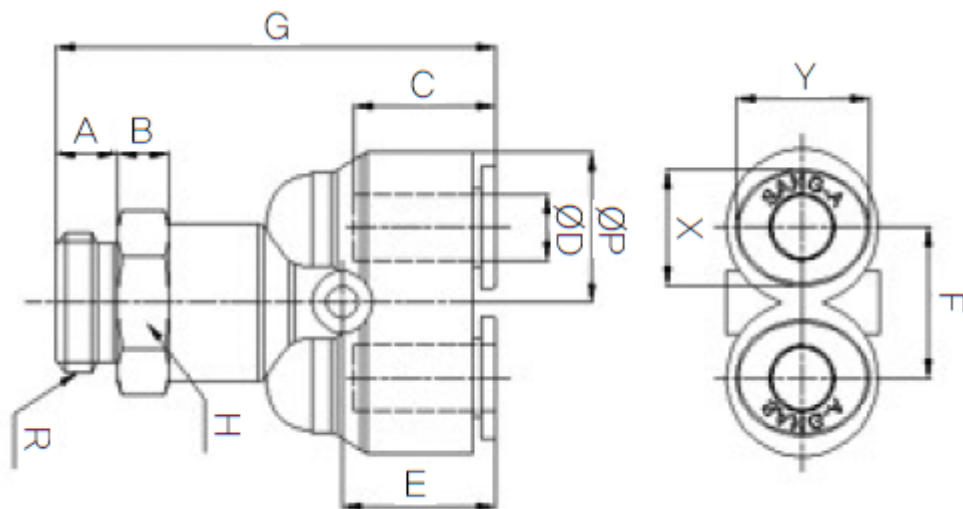

MODEL	ØD	ØP	A	B	C	E	F	G	R	H	X	Y
CR-PWT 04G01	4	11.8	5.3	8	14.5	13.1	10.8	40.7	PF 1/8	13	8.6	10.8
CR-PWT 04G02	4	11.8	6	8	14.5	13.1	10.8	41.4	PF 1/4	17	8.6	10.8
CR-PWT 06G01	6	14.7	5.3	8	15.6	14.9	13.6	44.8	PF 1/8	15	11	13
CR-PWT 06G02	6	14.7	6	8	15.6	14.9	13.6	45.5	PF 1/4	17	11	13
CR-PWT 08G01	8	16.7	5.3	8	17.3	18.1	15.4	51.9	PF 1/8	17	13	15
CR-PWT 08G02	8	16.7	6	8	17.3	18.1	15.4	52.6	PF 1/4	17	13	15
CR-PWT 08G03	8	16.7	7	8	17.3	18.1	15.4	53.6	PF 3/8	20	13	15
CR-PWT 10G02	10	19.3	6	8	19.4	17.5	17.7	54.5	PF 1/4	20	16	18.5
CR-PWT 10G03	10	19.3	7	8	19.4	17.5	17.7	55.5	PF 3/8	20	16	18.5
CR-PWT 10G04	10	19.3	8.5	8	19.4	17.5	17.7	57	PF 1/2	24	16	18.5
CR-PWT 12G02	12	23.2	6	8	22.4	20.9	21.5	61.7	PF 1/4	24	19.5	22.5
CR-PWT 12G03	12	23.2	7	8	22.4	20.9	21.5	62.7	PF 3/8	24	19.5	22.5
CR-PWT 12G04	12	23.2	8.5	8	22.4	20.9	21.5	64.2	PF 1/2	24	19.5	22.5

## Additional Information

---

EAN Code	8719426567395
Artikelnummer	CRPWT12-G04
Aansluiting 1	Buitendraad
Merk	Sang-A
Fabrikant	Sang-A
Materiaal	PVDF
Diameter	12mm
Draadmaat 1	1/2"
Draadsoort 1	BSPP
Vorm	Y